

AVENTOS HS top

Technical data sheet



www.blum.com

 **blum**

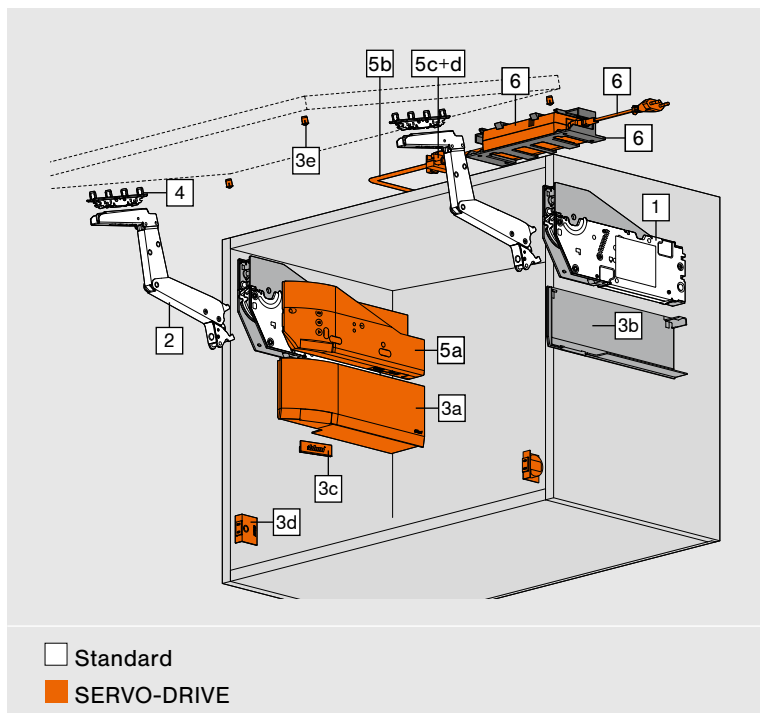

- Ideal for large, one-part fronts
- Cabinet height 350–800 mm
- Cabinet width up to 1800 mm
- Internal depth of at least 264 mm
- Integrated BLUMOTON adjustment
- SERVO-DRIVE electrical motion support system
- Light operating forces
- Variable stop
- Standardised position of the lift mechanism and front fixing bracket
- Symmetrical lift mechanism and lever arm
- Tool-free assembly
- Two lift mechanism fixing methods
- 3-dimensional adjustment of the front

Ordering information

Note

We recommend the more powerful lift mechanism for applications in overlapping ranges.
A trial application is recommended when you are in a borderline area of the individual lift mechanism.

The front weight (FG) can be increased by 50%, if you use a third lift mechanism.
We recommend a third lift mechanism for wide cabinets. This will prevent the front from sagging when open.

1		Lift mechanism set
		Fixing with pre-mounted system screws
	KH (mm)	FG (kg)
	350–450	2.00–11.50
	450–540	2.50–12.50
	480–660	2.75–15.25
	650–800	3.50–18.50
FG Front weight including double handle weight		
KH Cabinet height		
Consisting of:		
1	2 x	Symmetrical lift mechanism Incl. pre-mounted system screws



1		Lift mechanism set
		Fixing with chipboard screws with positioning system
	KH (mm)	FG (kg)
	350–450	2.00–11.50
	450–540	2.50–12.50
	480–660	2.75–15.25
	650–800	3.50–18.50
FG Front weight including double handle weight		
KH Cabinet height		
Consisting of:		
1	2 x	Symmetrical lift mechanism Incl. positioning system
-	8 x	Chipboard screws Ø 4 x 35 mm



Ordering information



2		Lever arm set		
		Colour	Material	
		NI	Steel	22S3500
Consisting of:				
2	2 x	Symmetrical lever arm		

3		Cover cap set		
		Colour	Material	
		SW, HGR, TGR	K	22.8000
Consisting of:				
-	1 x	Cover cap left		
3b	1 x	Cover cap right		
3c	2 x	Branding element, embossed with Blum logo		
		IN-G		

3		Cover cap set for SERVO-DRIVE		
		Colour	Material	
		SW, HGR, TGR	K	23.8000
Consisting of:				
3a	1 x	SERVO-DRIVE cover cap left		
3b	1 x	Cover cap right		
3c	2 x	Branding element, embossed with Blum logo		
		IN-G		
3d	2 x	SERVO-DRIVE switch		
3e	6 x	Blum distance bumper Ø 5 mm		

4			Front fixing bracket set	
	Version		Fixing method	
	Wooden fronts and wide aluminium frames		Screw-on ¹	20S4200
	Narrow aluminium frames		Screw-on ²	20S4200A
Consisting of:				
4	2 x	Front fixing bracket		
¹ Use 4 chipboard screws (609.1x00) per side for wooden fronts. Use 4 countersunk self-tapping screws (660.0950) per side for wide aluminium frames.				
² Incl. 8 x countersunk self-tapping screws – 660.0950				





-		Front fixing bracket		
		Version	Fixing method	
		Thin fronts	EXPANDO T 2 x	20S42T1
		Wooden fronts	EXPANDO 2 x	20S42E1

5		SERVO-DRIVE set		
		Colour	Material	
		TGR	K	23.A000

Consisting of:		
5a	1 x	Drive unit
5b	1 x	SERVO-DRIVE distribution cable, 1500 mm
5c	1 x	Connecting node
5d	2 x	Cable end protector
For three lift mechanisms or more, we recommend two synchronised drive units		
We recommend one drive unit per set for connected fronts.		

6		SERVO-DRIVE power supply unit and accessories
See page 4		

Optional

3c		Branding element		
	Material	Nylon		
		MOQ		
	Customised, printed branding element	From 1000pcs.		
	Customised, embossed branding element	From 5000pcs.		

Colours and material

Name	
SW	Silk white
HGR	Light grey
TGR	Dark grey
NI	Nickel plated
IN-G	In-mould brushed stainless steel
K	Nylon

SERVO-DRIVE power supply unit and accessories

Ordering information

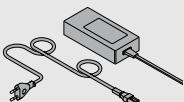
1				SERVO-DRIVE power supply unit incl. flex			
							
Markets		Language package					
K		I		Z10NE04KI			
Incl. operating and installation instructions							
Consisting of:							
1a		1 x	SERVO-DRIVE power supply unit				
1b		1 x	Flex				

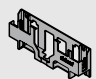
2		Power supply unit housing					
		Panel fixing					
		Colour		Material			
		WGR		K		Z10NG120	
For SERVO-DRIVE power supply unit							

Accessories

3		SERVO-DRIVE distribution cable and cable end protector		
		Colour	Length (m)	
		S	8	Z10K800AE
Consisting of:				
3a	1 x	SERVO-DRIVE distribution cable		
3b	5 x	Cable end protector		
For cutting to size				

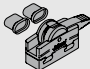
4		Connecting node and cable end protector		
		Colour	Material	
		S	K	Z10V100E.01
Consisting of:				
4a	1 x	Connecting node		
4b	2 x	Cable end protector		

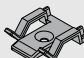
-		Cable holder		
		Colour	Material	
		W	K	Z10K0009
E.g. for fixing the SERVO-DRIVE distribution cable				

Colours and material

Name	
WGR	White grey
S	Black
W	White
K	Nylon

Planning

Wooden fronts and wide aluminium frames

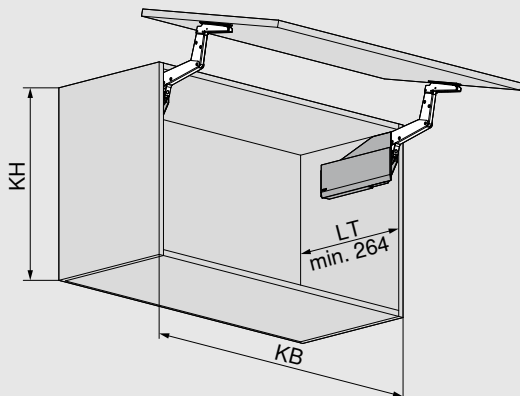

KB Cabinet width

KH Cabinet height

LT Internal cabinet depth

Narrow aluminium frames

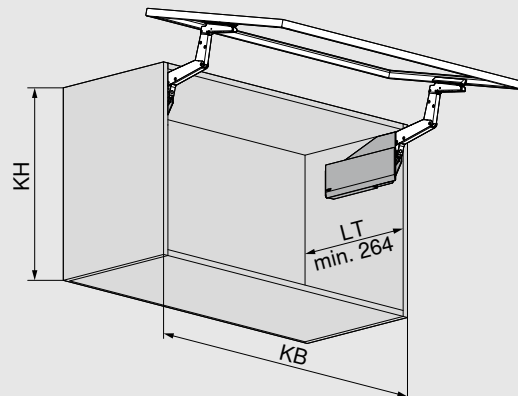

KB Cabinet width

KH Cabinet height

LT Internal cabinet depth

Drilling position

System screws

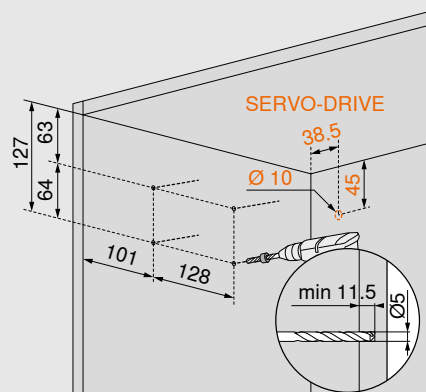

Chipboard screws incl. positioning system

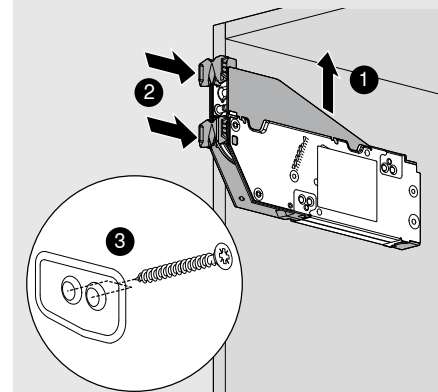
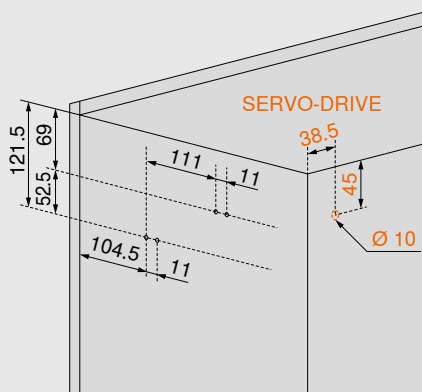

Space requirement

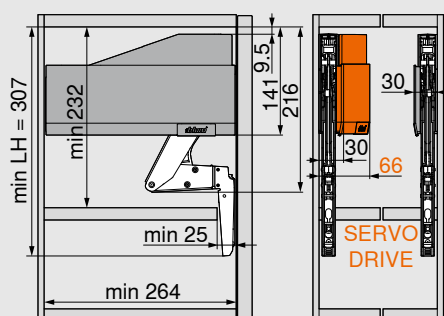

LH Internal cabinet height

Front setting

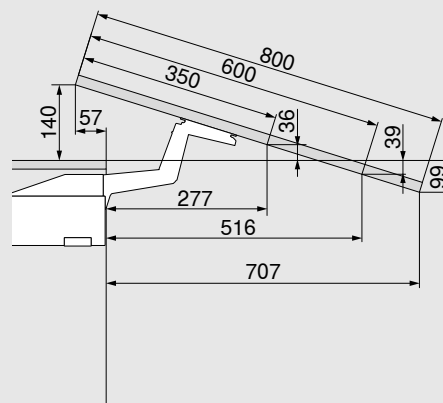

Dimensions depend on tilt adjustment

Planning

Front assembly

Wooden fronts and wide aluminium frames

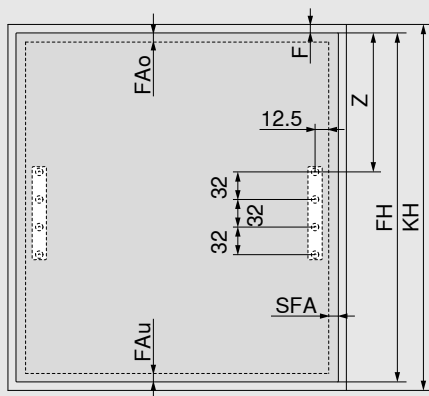

FAo Upper front overlay

FAu Bottom front overlay

F Gap

Z 195 + FAo

FH Front height

KH Cabinet height

SFA Side front overlay

Wall application: minimum 5 mm gap

Narrow aluminium frames

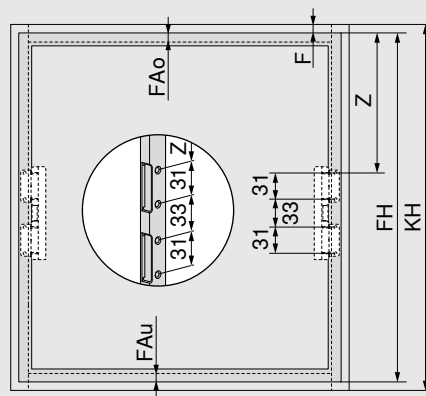

FAo Upper front overlay

FAu Bottom front overlay

F Gap

Z 195.5 + FAo

FH Front height

KH Cabinet height

Wall application: minimum 5 mm gap

Narrow aluminium frames

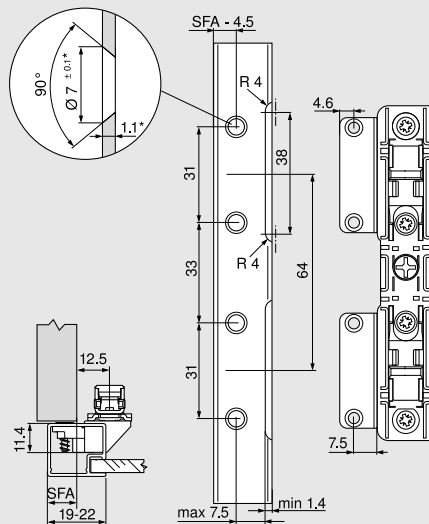

For frame width 19 mm, an SFA of 11-18 mm is possible.

* When changing material thickness, adjust the assembly dimensions accordingly

SFA Side front overlay

Space requirement – cornice | crown moulding

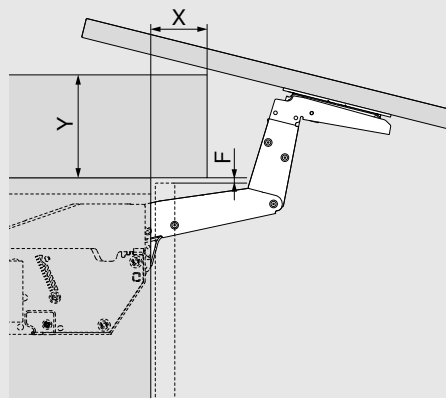

F (mm)	3.0	2.0	1.5
X max. (mm)	31	29	27
Y max. (mm)	117	118	119
F Gap			



Find more information on assembly
and adjustment of AVENTOS HS top at
www.blum.com/hstopassembly

SERVO-DRIVE for AVENTOS HS top

Planning

Blum distance bumper (SERVO-DRIVE application only)

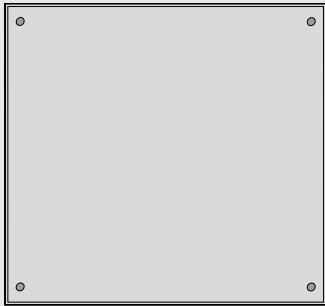

Insert Blum distance bumper (do not glue)

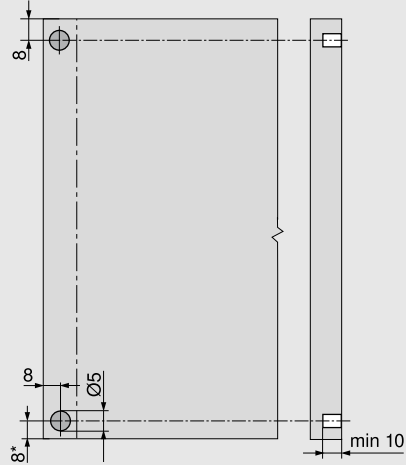

Recommendation for aluminium frames

Drill hole into cabinet side for Blum distance bumper

A trial application must be carried out if fixed to the front

* From cabinet bottom edge for fronts that protrude below

SERVO-DRIVE switch

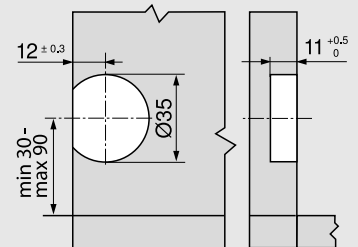

Our EASY ASSEMBLY app provides
information about assembly and adjustment
of AVENTOS HS top and SERVO-DRIVE

www.blum.com/eaapp

SERVO-DRIVE power supply unit and accessories

Planning

Space requirement and safety distance

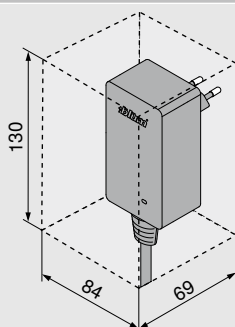
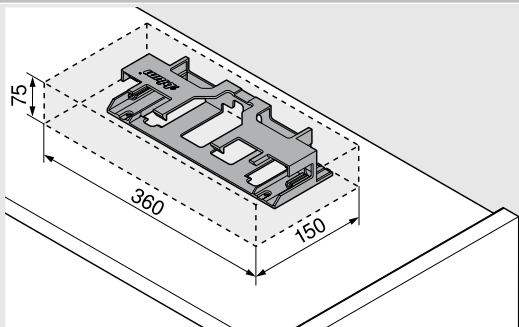

i A safety distance of 30 mm must be maintained for air circulation (see graphic); otherwise, there is a risk that the SERVO-DRIVE power supply unit could overheat.

Assembly on the cabinet top panel

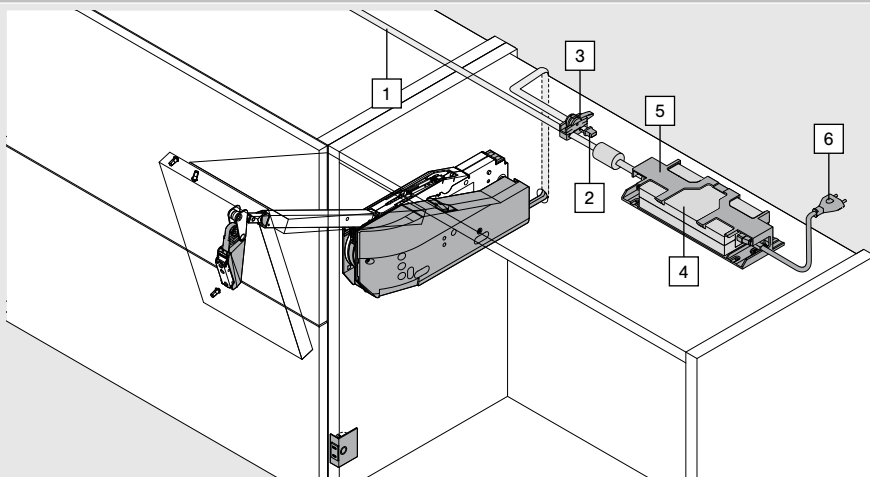

- 1 SERVO-DRIVE distribution cable
- 2 Connecting node
- 3 Cable end protector
- 4 SERVO-DRIVE power supply unit
- 5 Power supply unit housing
- 6 Flex

i Only one SERVO-DRIVE power supply unit can be connected to each SERVO-DRIVE distribution cable!

Back cabling

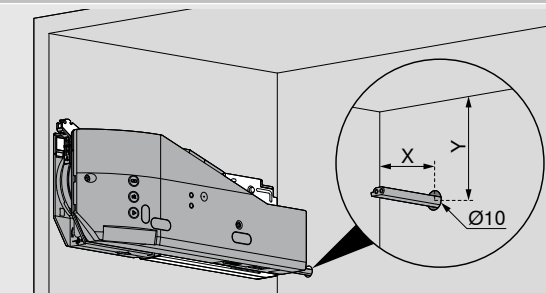

AVENTOS HS top

X (mm)	Y (mm)
38.5	45



Find more information on assembly and adjustment of SERVO-DRIVE for AVENTOS top at
www.blum.com/servodrive-aventos-assembly

 **Instagram:**
@blumaustralia, #blumaustralia

 **Facebook:**
facebook.com/blumaustralia

 **LinkedIn:**
linkedin.com/company/blum-australia

 **TikTok:**
tiktok.com/@blumaustralia

 **Pinterest:**
pinterest.com/blumaustralia/

 **Android App on Google Play:**
Easy Assembly App

 **Available on the App Store:**
Easy Assembly App

**Blum Showrooms
Sydney (Head Office)**

10 Blackbird Close
Len Waters Estate NSW 2170
Ph: 02 9612 5400

Adelaide

179 Railway Terrace
Mile End SA 5031
Ph: 08 8118 6070

Brisbane

6/39-45 Compton Road
Underwood QLD 4119
Ph: 07 3135 9490

Melbourne

245 Ferntree Gully Road
Mount Waverley VIC 3149
Ph: 03 9982 1720

Perth

3/425 Scarborough Beach Road
Osborne Park WA 6017
Ph: 08 6467 0110

Blum Australia Pty Ltd
PO BOX 1615
Green Valley, NSW, 2168
Australia
Toll Free: 1800 179 186
E-mail: info.au@blum.com
blum.com

